

ST. CLOUD ROOFTOP FLOOR PLAN

Exclusive, versatile and completely unique, the St. Cloud rooftop offers the ultimate New York City function space for hosting corporate and social events that are sure to be memorable. Situated 17 floors above Times Square, the rooftop offers both indoor and outdoor space with unrivaled views of the city skyline.

	Sq. Ft.	Sq. Meters	Reception
ROOFTOP			
Total Rooftop	7,800	724	250
INDOOR AREA			
1. Club Room	800	74	60
2. Waterford Lounge	840	78	30
3. St. Cloud Bar & Perimeter Seating	1,000	93	60
OUTDOOR AREA			
4. 42nd Street Pod	200	19	25
5. 42nd Street Lounge	1,500	139	80
6. Times Square Pod	240	22	20
7. Times Square Lounge	1,000	93	75
8. Broadway Pod	140	13	12
9. Broadway Cigar Lounge	500	46	35

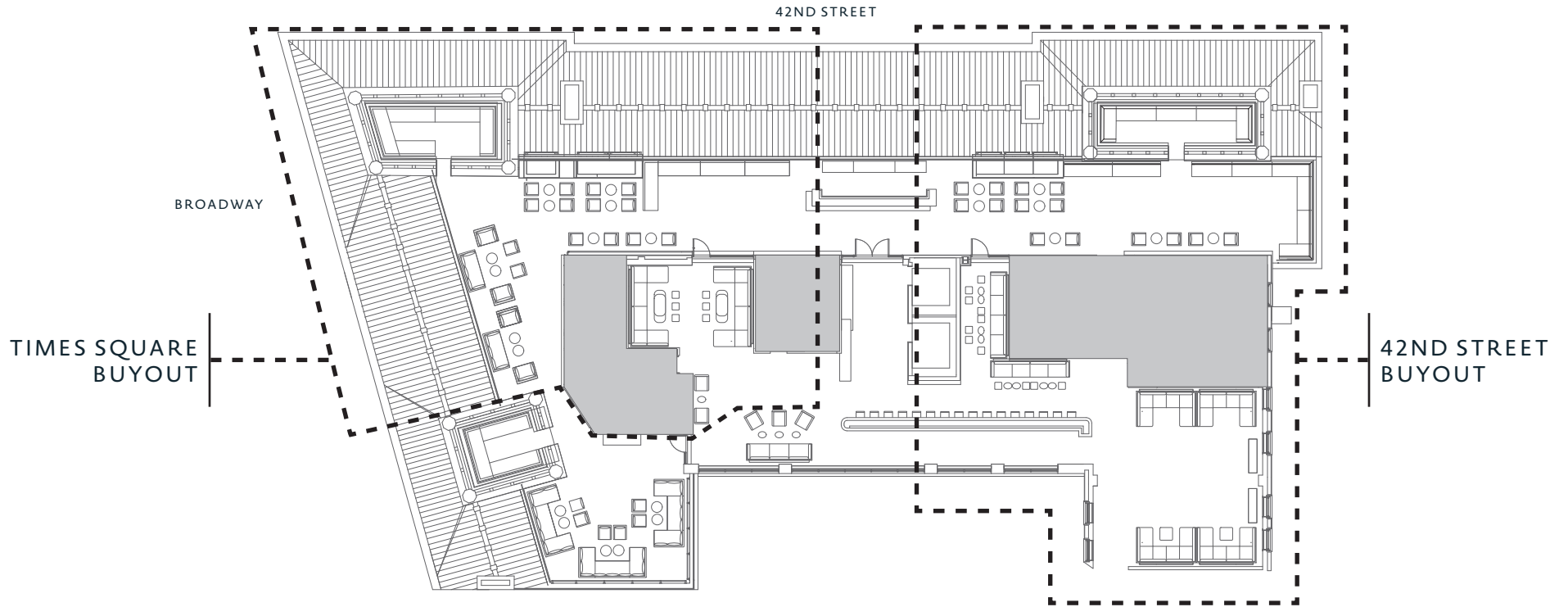

ST. CLOUD ROOFTOP FLOOR PLAN

The St. Cloud rooftop can be reserved in its entirety or as two partial configurations that each offer indoor and outdoor event space.

	Sq. Ft.	Sq. Meters	Reception
BUYOUTS INDOOR & OUTDOOR			
Total Buyout, Indoor & Outdoor	7,800	724	250
42nd Street Partial Buyout, Indoor & Outdoor	2,500	232	175
Times Square Partial Buyout, Indoor & Outdoor	2,700	251	125

CHARLIE PALMER AT THE KNICK AND THE SALON FLOOR PLAN

Echoing the hotel's contemporary elegance, Charlie Palmer at The Knick and The Salon are located on the fourth floor and feature exceptional views of Midtown Manhattan. From power breakfast meetings to intimate social gatherings, the space is ideal for one-of-a-kind engagements.

	Length	Width	Sq. Ft.	Sq. Meters	Reception	Seated	Banquet	Theater	Classroom	U-Shape
FOURTH FLOOR										
1. The Salon	41	54	2,200	204	160	-	100	150	60	36
2. Salon Foyer	-	-	450	42	40	-	-	-	-	-
3. Charlie Palmer Bar & Lounge										
4. Library Foyer	-	-	1,200	111	60	30				
5. The Library	-	-	-	-	40	36				
6. Charlie Palmer Main Dining Room	-	-	1,600	149	125	90				
Total Buyout	-	-	-	-	300	95				

